

## Horpol LED marker light with reversing-sensor - 12V-24V

LED marker-lamps by Horpol with built-in yellow marker-light and reversing-sensor, that flashes faster and faster as you approach an object.

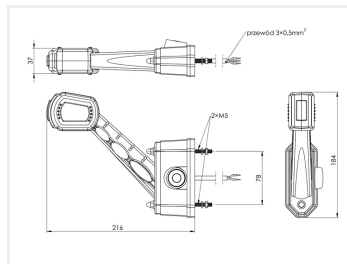
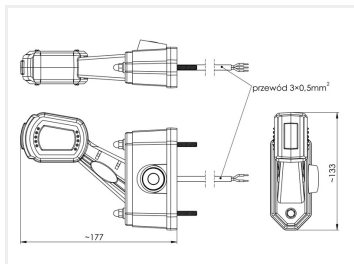

LED marker-lamp by Horpol with built-in yellow marker-light and reversing-sensor, so that you avoid reversing into objects. It flashes faster and faster as you approach an object like a wall, ramp or other vehicles. If you come within 80cm an object it will light up constantly and indicate the end.

The marker-lamps are multivolt (12V-24), so that you can mount them on your car, van, truck, bus etc.

Available in a short and long version and for the left and the right side.

Everything you need for mounting is included. The marker-lamps are E-approved.

Buy online at:

[www.matronics.eu/24605080](http://www.matronics.eu/24605080)

### Specifications

Voltage	12-24V
Consumption 12V / 24V	0,5 / 1W
Cable length	1,5 meters
Cable thickness	3x0,5 mm2

### Connection:

- White = Ground
- Red = Marker-lights
- Blue = Reversing-light



#### Short, Left

SKU 24605080

Dimensions: 133 x 177 x 37mm



#### Short, Right

SKU 24605081

Dimensions: 133 x 177 x 37mm



#### Long, Left

SKU 24605084

Dimensions: 184 x 216 x 37mm



#### Long, Right

SKU 24605085

Dimensions: 184 x 216 x 37mm

# Product pictures

