

5-30V Motion sensor with DC-stik

A compact motion-sensor that turns on the power when it senses any motion. A black and a white model.

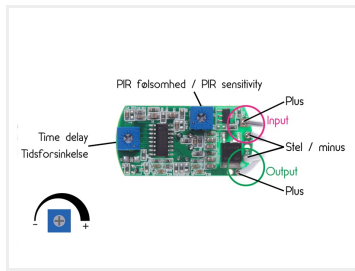

A compact PIR sensor that turns on the power when movement is detected.

It is easy to connect with DC-connectors in both input and output, making it easy to connect a power supply. There is 30cm cable on the input and the output. If you want to use DC connectors with screw terminals, you need DC connectors with 2.1mm inner diameter.

It can be connected from 5V to 30V and the outputs have the same voltage as the input.

The delay can be set up from 2 to 30 seconds.

Buy online at:

www.matronics.eu/606611

Specifications

Max current	1.5A
Voltage	5-30V
Delayed off	2-30 seconds
Sensor angle	about 110 degree
Sensor distance	5-7m or under (adjustable)
Consumption	0,1 Watt



White
SKU 606611



Black
SKU 606611-S

Product pictures

