

## Multi-Flare Holder for Traffic - Cone

A Multi-flare holder that can be attached to traffic-cones or similar. You will need a metal top, as you put the multi-flares magnet on.

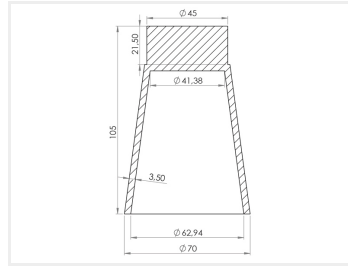

A multi-flare holder that can be stuck on traffic-cones or similar. You will need a metal top, as you put the multi-flares magnet on.

With a multi-flare suitcase and 6 cones you can quickly set up highly visible shutoff, so as to ensure the region against impact.

There is a slit in the cradle, so that it can be pressed firmly down over the top of the cone.

Buy online at:

[www.matronics.eu/500550](http://www.matronics.eu/500550)



**Multi-Flare Holder for Traffic - Cone**

SKU 500550

Product pictures

