

## Auspicious T2 – Selector switch

Selector switch for mounting in Ø22mm hole. Available with 2 or 3 positions. Easy mounting with NC and NO terminals.

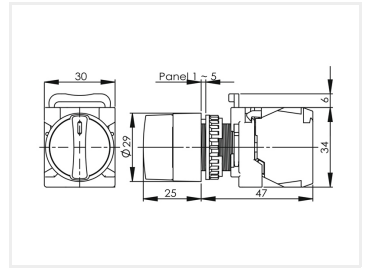
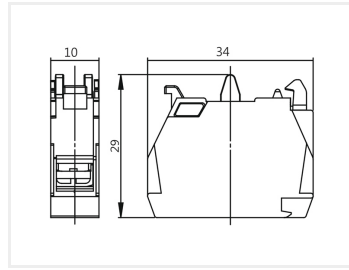

Selector switch for mounting in Ø22mm hole. Available with 2 or 3 positions. Easy mounting with NC and NO terminals.

To assemble a complete switch you need to order the following parts for a complete kit :

- Switch
- Coupling
- Contact-block (1-2 pcs.)

The 2 position switch swaps between activating the mounted contact blocks. The 3 position does the same, but the middle position does not activate any contact blocks.

### Coupling

The coupling is simple pushed on to the bottom of the switch. The coupling is easy to take of again, by pushing the yellow parts, and pulling the coupling from the switch. This makes it easy to connect and replace.

### Contact-blocks

There is space for 2 contact blocks on a coupling. These are simply places in the coupling where they fasten. They are easy to remove again. The contact-blocks are activated when the switch is pushed down.

- NO contact block (green) connects the two screw-terminals when activated
- NC contact block (red) disconnects the two screw-terminals when activated

Buy online at:

[www.matronics.eu/519020](http://www.matronics.eu/519020)



**Arm, 2 positions**  
SKU 519020



**Accessory, Coupling (required)**  
SKU 519510



**Accessory, Contact block (NO)**  
SKU 519500



**Arm, 3 positions**  
SKU 519021



**Accessory, Contact block (NC)**  
SKU 519501

Product pictures

